

\$79,000 - 22 Susquehanna Avenue, Rural Cardston County

MLS® #A2240068

\$79,000

0 Bedroom, 0.00 Bathroom,
Land on 3.22 Acres

NONE, Rural Cardston County, Alberta

Room to Dream! A beautiful 3.2-acre parcel offering the best of Southern Alberta's natural charm. With its gently rolling land and long western viewlines, this property is perfectly positioned for spectacular sunsets and tranquil country living. Whether you're looking to build your forever home or create a peaceful Airbnb retreat, this lot offers the space and setting to bring your vision to life. Located just 5 minutes from the town of Cardston, you'll enjoy the quiet of rural life without giving up convenience. Electricity and natural gas are nearby, ready to be brought into the lot, and you have the option of digging a well or hauling water. The area is known for its wide open skies, mountain views. With Waterton Lakes National Park just 30 minutes away, and the sandy Wally's beach at St. Mary's Reservoir only a short drive, this property gives you the perfect blend of serenity, adventure, and potential. Call your favourite REALTOR® today to learn more!

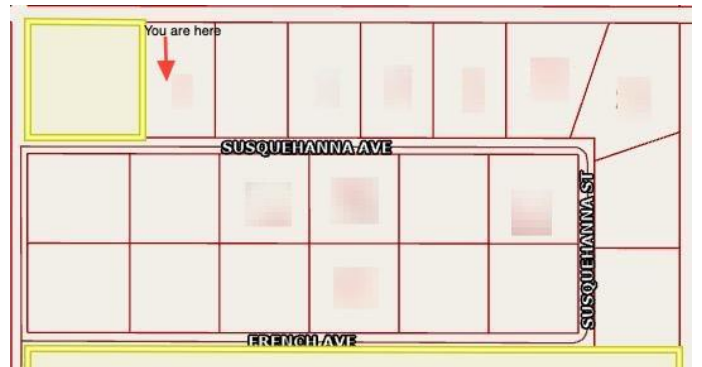
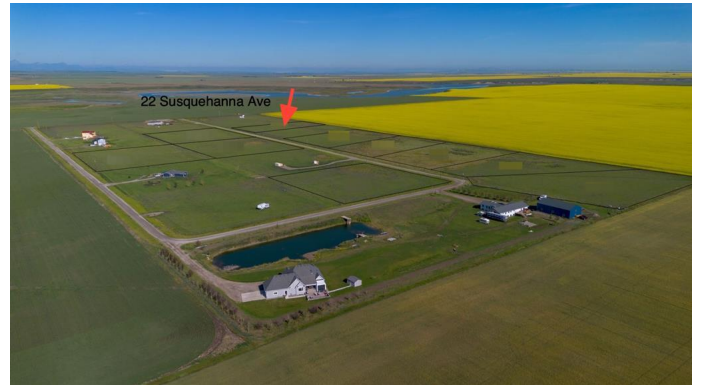

Essential Information

MLS® #	A2240068
Price	\$79,000
Bathrooms	0.00
Acres	3.22
Type	Land

Sub-Type	Residential Land
Status	Active

Community Information

Address	22 Susquehanna Avenue
Subdivision	NONE
City	Rural Cardston County
County	Cardston County
Province	Alberta
Postal Code	T0K 0K0

Additional Information

Date Listed	July 14th, 2025
Days on Market	61
Zoning	GCR

Listing Details

Listing Office	Grassroots Realty Group
----------------	-------------------------

Data is supplied by Pillar 9â„¢ MLSÂ® System. Pillar 9â„¢ is the owner of the copyright in its MLSÂ® System. Data is deemed reliable but is not guaranteed accurate by Pillar 9â„¢. The trademarks MLSÂ®, Multiple Listing ServiceÂ® and the associated logos are owned by The Canadian Real Estate Association (CREA) and identify the quality of services provided by real estate professionals who are members of CREA. Used under license.