

# \$389,900 - 8, 32580 Range Road 11 Road, Rural Mountain View County

MLS® #A2237001

**\$389,900**

0 Bedroom, 0.00 Bathroom,  
Land on 2.57 Acres

NONE, Rural Mountain View County, Alberta

Olds Alberta-Mountainview County. Netook Crossing BUSINESS PARK 2.57 acres M/L. Excellent location with great exposure and backs onto highway 27 and close to the entrance of the Business park. A few lots east of the Large CO-OP Card lock. Situated among Dodge Dealership, Self Storage lot, Integrity R.V, Volker Stevin, and many other businesses. Ideal for Animal Health Centre, Industrial Storage, Manufacturing, Auto related uses, Recycling Depot and more. Lot size is 62 meters front, 125 meters east, 141 meters west, 82 meters north and Zoning and site map all in supplements.

## Essential Information

MLS® #	A2237001
Price	\$389,900
Bathrooms	0.00
Acres	2.57
Type	Land
Sub-Type	Industrial Land
Status	Active

## Community Information

Address	8, 32580 Range Road 11 Road
Subdivision	NONE
City	Rural Mountain View County

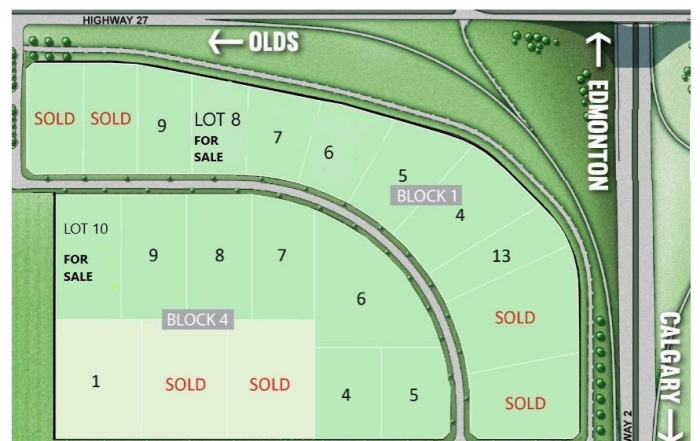

County	Mountain View County
Province	Alberta
Postal Code	T0M 1X0

### **Additional Information**

Date Listed	July 4th, 2025
Days on Market	50
Zoning	6

### **Listing Details**

Listing Office	Royal LePage Blue Sky
----------------	-----------------------

Data is supplied by Pillar 9â„¢ MLSÂ® System. Pillar 9â„¢ is the owner of the copyright in its MLSÂ® System. Data is deemed reliable but is not guaranteed accurate by Pillar 9â„¢. The trademarks MLSÂ®, Multiple Listing ServiceÂ® and the associated logos are owned by The Canadian Real Estate Association (CREA) and identify the quality of services provided by real estate professionals who are members of CREA. Used under license.