

# \$279,000 - 344048 Range Road 4-5, Rural Clearwater County

---

MLS® #A2217297

**\$279,000**

0 Bedroom, 0.00 Bathroom,  
Land on 6.15 Acres

NONE, Rural Clearwater County, Alberta

For more information, please click Brochure button.

Beautiful new acreage with pine and poplar mixed woods and open meadow. 6.15 acres half a mile north of highway 587 on a quiet road. A new water well is in place with good flow and water quality test completed and available. Gas and electrical power available. Land line telephone and internet service is also accessible if desired. Red Deer river close by and crown land a little to the west. The city of Sundre with services including shopping and a hospital less than 15 minute drive away. Not too far from anything but far enough away from everything. Good rural neighbours too.

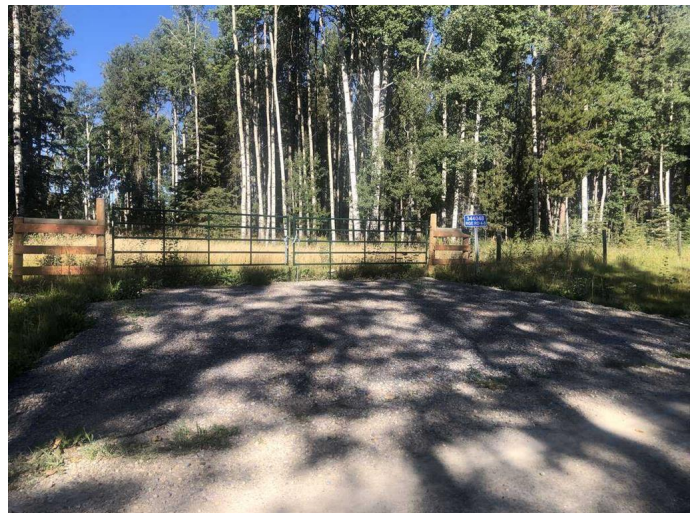

## Essential Information

MLS® #	A2217297
Price	\$279,000
Bathrooms	0.00
Acres	6.15
Type	Land
Sub-Type	Residential Land
Status	Active

## Community Information

Address	344048 Range Road 4-5
Subdivision	NONE
City	Rural Clearwater County

County	Clearwater County
Province	Alberta
Postal Code	T4G 0L9

### Exterior

Lot Description	Many Trees, Meadow, No Neighbours Behind, Pasture, Rectangular Lot, Secluded, Treed, Wooded
-----------------	---------------------------------------------------------------------------------------------

### Additional Information

Date Listed	May 2nd, 2025
Days on Market	1
Zoning	CR

### Listing Details

Listing Office	Easy List Realty
----------------	------------------

Data is supplied by Pillar 9â„¢ MLS® System. Pillar 9â„¢ is the owner of the copyright in its MLS® System. Data is deemed reliable but is not guaranteed accurate by Pillar 9â„¢. The trademarks MLS®, Multiple Listing Service® and the associated logos are owned by The Canadian Real Estate Association (CREA) and identify the quality of services provided by real estate professionals who are members of CREA. Used under license.